

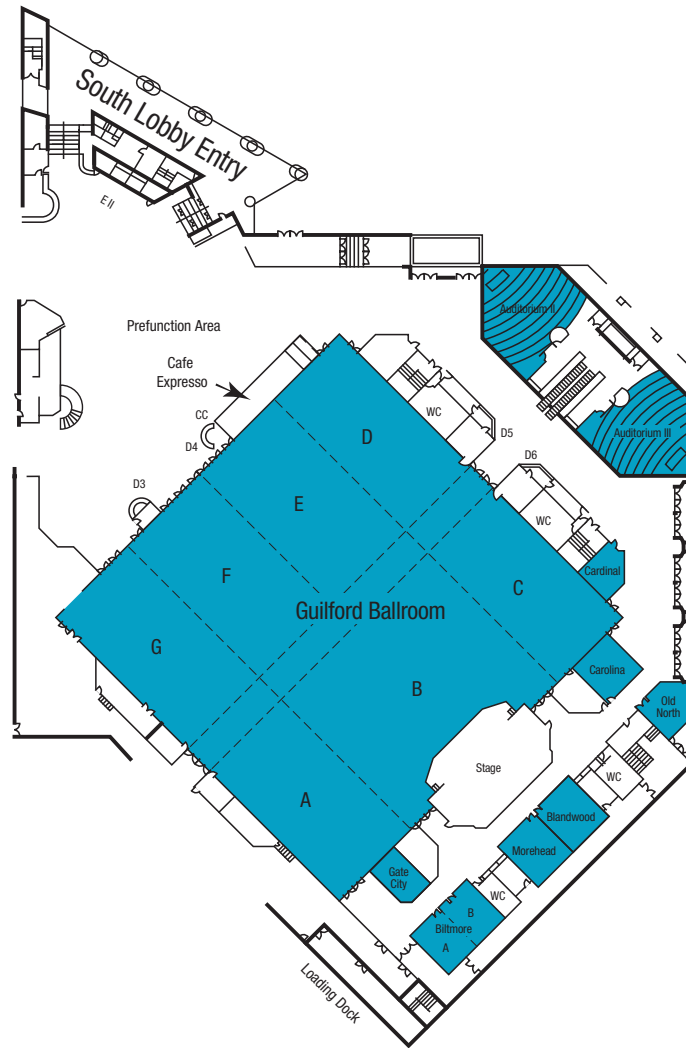

Sheraton

FIRST FLOOR
GUILFORD
BALLROOM



ROOM DIMENSIONS AND SEATING CAPACITY

Room Name	Reception or Theatre	Classroom	Banquet	Ovals of 10	Length X Width	Square Feet	Ceiling Height
Gate City		Permanent Conference for 14			25' x 17'	425	11'
Biltmore	100	55	75	60	36' x 28'	1,008	11'
Biltmore A	45	25	40	20	28' x 18'	504	11'
Biltmore B	45	25	40	20	28' x 18'	504	11'
Morehead	60	30	55	40	28' x 25'	700	11'
Blandwood	60	30	55	40	28' x 25'	700	11'
Carolina	40	27	30	30	26' x 24'	624	11'
Old North		Permanent Conference for 16			25' x 22'	550	11'
Cardinal		Permanent Conference for 10			23' x 19'	437	11'
Auditorium II		Permanent Classroom Seating for 154					
Auditorium III		Permanent Classroom Seating for 154					
Prefunction Area		30,000 Square Feet					
Guilford Ballroom	6,000	2,800	4,075	2,880	200' x 200'	40,000	32'
Guilford A	(R) 600 (T) 555	280	350	320	90' x 50'	4,500	32'
Guilford B	1,100	520	700	560	100' x 90'	9,000	32'
Guilford C	555	280	350	320	90' x 50'	4,500	32'
Guilford D	550	280	350	320	90' x 50'	4,500	32'
Guilford E	580	280	350	320	90' x 50'	4,500	32'
Guilford F	580	280	350	320	90' x 50'	4,500	32'
Guilford G	550	280	350	320	90' x 50'	4,500	32'
Corridor					200' X 20'	4,000	32'

Sheraton Greensboro Hotel at Four Seasons

GREENSBORO, NORTH CAROLINA

3121 High Point Road

t — 336 292 9161

sheratongreensboro.com

FIRST FLOOR
IMPERIAL
BALLROOM

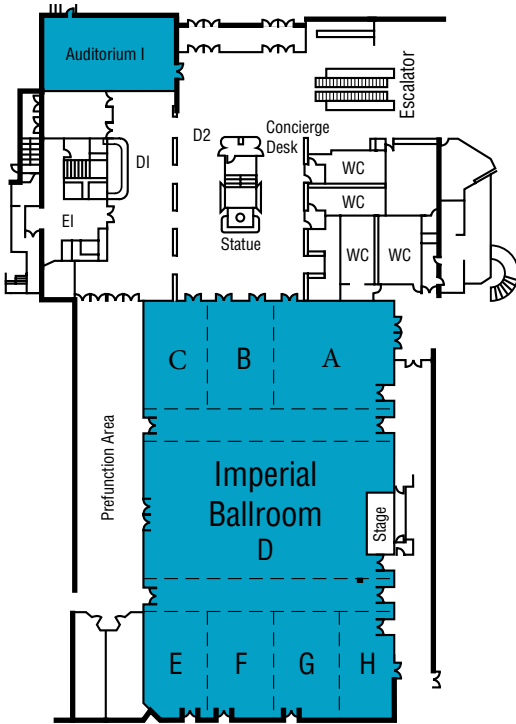

SECOND FLOOR
MEETING
ROOMS

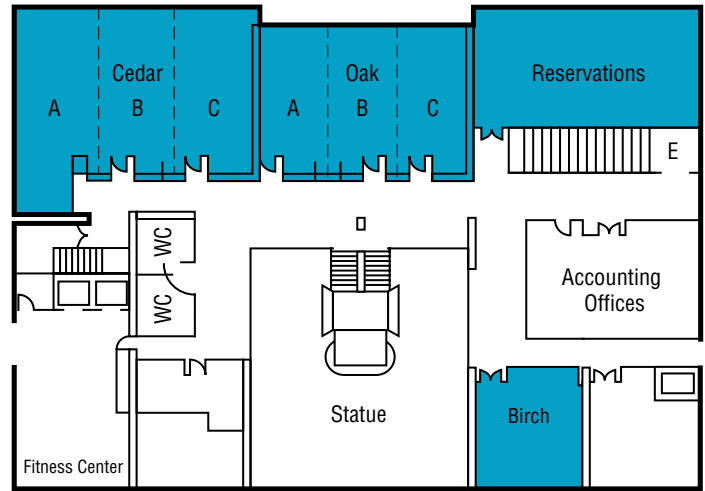

ROOM DIMENSIONS AND SEATING CAPACITY

Room Name	Reception or Theatre	Classroom	Banquet	Ovals of 10	Length X Width	Square Feet	Ceiling Height
Imperial Ballroom	1,900	1,200	1,190	1,000	165' x 100'	16,500	16'-20'
Imperial A	185	125	150	110	48' x 43'	2,064	16'-18'
Imperial B	115	65	75	60	43' x 26'	1,118	16'-18'
Imperial C	110	60	70	60	43' x 25'	1,075	16'-18'
Imperial D	600	360	435	370	100' x 54'	5,400	16'-20'
Imperial E	75	35	50	40	42' x 25'	1,050	16'-18'
Imperial F	115	50	70	60	42' x 26'	1,092	16'-18'
Imperial G	115	50	70	60	42' x 26'	1,092	16'-18'
Imperial H	85	30	50	40	42' x 22'	924	16'-18'
Additional each aisle					100' x 13'	1,300	18'
Auditorium I	Permanent Theatre Seating for 118						
Prefunction Area	10,000 Square Feet						
Cedar	225	100	160	130	53' x 33'	1,749	8'-8'6"
Cedar A	60	35	45	40	37' x 17'	629	8'-8'6"
Cedar B	50	30	40	30	33' x 17'	561	8'-8'6"
Cedar C	50	30	40	30	33' x 17'	561	8'-8'6"
Oak	195	100	100	110	50' x 33'	1,650	8'-8'6"
Oak A	50	30	30	30	33' x 17'	629	8'-8'6"
Oak B	50	30	40	30	33' x 17'	561	8'-8'6"
Oak C	50	30	40	30	33' x 17'	561	8'-8'6"
Birch	50	30		40	24' x 24'	576	7'6"-8'

THIRD FLOOR
MEETING
ROOMS
PREFUNCTION
VICTORIA WING

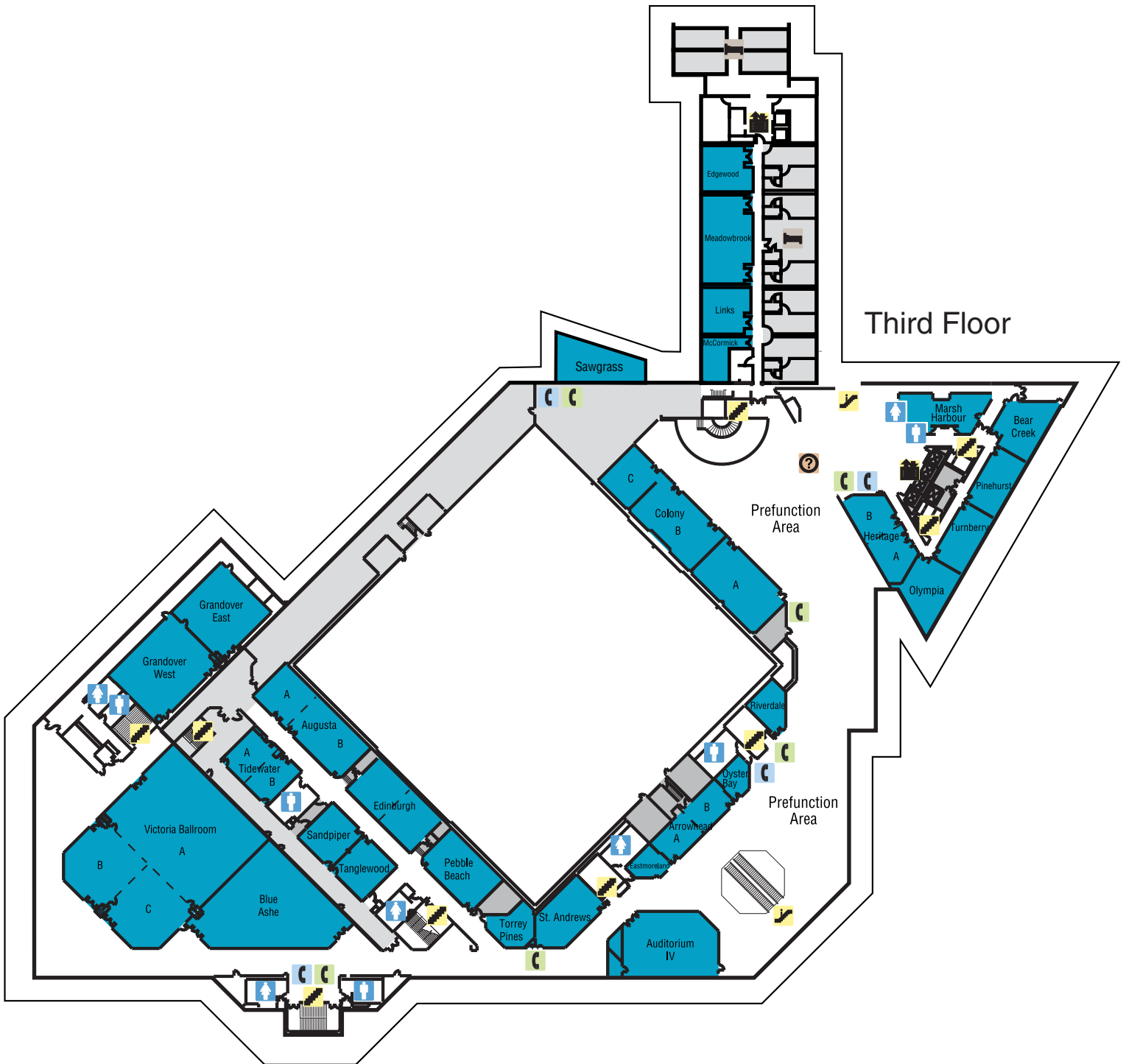

Third Floor

THIRD FLOOR
MEETING
ROOMS
PREFUNCTION
VICTORIA WING



ROOM DIMENSIONS AND SEATING CAPACITY

Room Name	Reception or Theatre	Classroom	Banquet	Ovals of 10	Length X Width	Square Feet	Ceiling Height
Augusta	140	100	115	110	67' x 26'	1,742	11'
Augusta A	40	30	50	40	26' x 25'	650	11'
Augusta B	100	65	65	70	42' x 26'	1,092	11'
Tidewater	100	55	75	60	36' x 27'	972	11'
Tidewater A	45	25	40	20	27' x 18'	486	11'
Tidewater B	45	25	40	20	27' x 18'	486	11'
Edinburgh		Permanent Conference for 34			52' x 26'	1,352	11'
Sandpiper	60	30	55	40	27' x 25'	675	11'
Tanglewood	60	30	55	40	27' x 25'	675	11'
Pebble Beach	100	65	100	70	41' x 26'	1,066	11'
Torrey Pines		Permanent Conference for 12			25' x 18'	450	11'
St. Andrews		Permanent Conference for 20			22' x 22'	484	11'
Auditorium IV		Permanent Theater Seating for 188					
Eastmoreland		Permanent Conference for 8			19' x 18'	342	11'
Arrowhead	60	30	40	40	50' x 18'	900	11'
Arrowhead A	30	15	35	20	25' x 18'	450	11'
Arrowhead B	30	15	35	20	25' x 18'	450	11'
Oyster Bay		Permanent Conference for 8			19' x 18'	342	11'
Riverdale		Permanent Conference for 12			23' x 22'	506	11'
Colony	330	180	260	170	126' x 29'	3,654	11'
Colony A	130	70	75	80	50' x 29'	1,450	11'
Colony B	130	70	130	80	50' x 29'	1,450	11'
Colony C	50	30	55	40	29' x 26'	754	11'
Marsh Harbour		Permanent Conference for 12			23' x 23'	529	11'
Bear Creek		Permanent Conference for 20			31' x 26'	806	11'
Pinehurst	60	30	35	40	36' x 19'	684	11'
Turnberry	60	30	35	40	36' x 19'	684	11'
Olympia		Permanent Conference for 20			31' x 26'	806	11'
Heritage	70	50	50	60	52' x 23'	1,196	11'
Heritage B	45	25	35	30	26' x 23'	598	11'
Heritage C	45	25	35	30	26' x 23'	598	11'
Prefunction Area		30,000 Square Feet					
Edgewood		Permanent Conference for 20			25' x 23'	575	7'6"-8'
Meadowbrook	125	80	110	80	51' x 23'	1,173	7'6"-8'
Links		Permanent Conference for 20			25' x 23'	575	7'6"-8'
McCormick		Permanent Conference for 10			25' x 18'	450	7'6"-8'
Victoria Ballroom	660	408		460	97' x 75'	7275	13'
Victoria A	400	240		300	58' x 75'	4350	13'
Victoria B	125	72		80	39' x 37'	1443	13'
Victoria C	125	72		80	39' x 37'	1443	13'
Grandover Room	400	256		210	88' x 40'	3520	13'
Grandover East	130	88		90	39' x 39'	1560	13'
Grandover West	180	120		120	49' x 39'	1955	13'
Blue Ashe Room	340	200		200		3340	13'